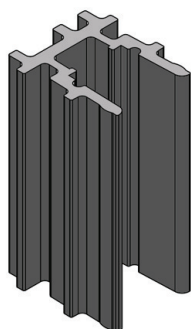
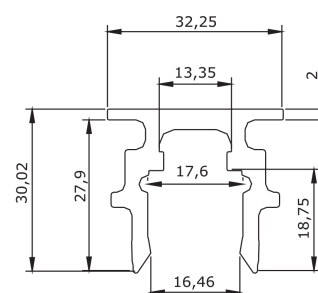

Série / Serie / Série / System
 N24000

Ref./Code
 1638P

Espec. / Caract. / Spec.
 PA66

QTY / GR
 400 7540

Série / Serie / Série / System
 N24000

Ref./Code
 1554P

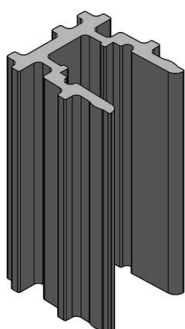
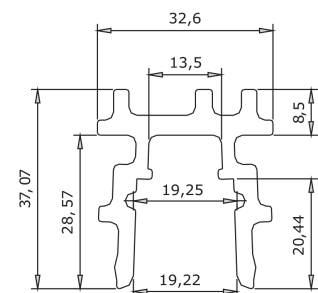
Espec. / Caract. / Spec.
 POM

QTY / GR
 200 6630

Série / Serie / Série / System
 RTC

Ref./Code
 1555P

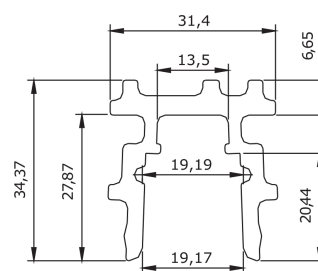
Espec. / Caract. / Spec.
 POM

QTY / GR
 200 6150

Série / Serie / Série / System
 N24000

Ref./Code
 F1554P

Espec. / Caract. / Spec.
 PA66

QTY / GR
 200 5285
